

## 1-Channel circuit breaker EasyB 1-Channel



### General Data

|   |
|---|
| 24 Vdc 1-channel circuit breaker system                             |
| Efficiency up to 99 %   |
| Multi-coloured LED and status display button                        |
| Up to 40 fuse channels stackable side by side                       |
| Optionally with current limitation or thermomagnetic characteristic |
| Common signalling output for tripped and switched off channels      |
| Ambient temperature -25 °C to +70 °C                                |
| Protection index IP 20  |

### Advantages

|   |
|---|
| Automatic channel assignment  |
| Optional communication via communication modules                        |
| Optional undervoltage shutdown in combined network                      |
| Optional settings for tripping current                                  |
| Additional load outputs through output expanders mountable side by side |
| Selective load-dependent activation                                     |
| Versions with collective reset input                                    |

### Applications

EB-27 Electronic circuit breaker with thermomagnetic characteristic with alarm signal forwarded for tripped and switched off channels to the connected channels. Starter version with fuse for 24 V loads.

EB-28 Electronic circuit breaker with current-limiting characteristic with alarm signal forwarded for tripped and switched off channels to the connected channels. Starter version with fuse for 24 V loads if active current limitation is required.

EB-08, EB-18, EB-38 Electronic circuit breaker with current-limiting characteristic and comprehensive communication with the connected modules. Suitable as advanced fuse for 24 V loads with option of reading more detailed current supply parameters and actively controlling the channels.

### Standards

Safety:  
EN 60950-1, EN 50178, EN/IEC 60204-1

EMC:  
EN 61000-6-2 (interference immunity), EN 61000-6-3 (emitted interference)

CE acc. to 2014/30/EU

### Approvals



UL 508 (prepared), UL 2367 (prepared), GL (prepared)



## 1-Channel circuit breaker EasyB 1-Channel



| Typ   | EB-0824-100-0   | EB-1824-010-0   | EB-1824-020-0   | EB-1824-030-0   |
|---|---|---|---|---|
| <b>Electrical data</b>                            |   |   |   |   |
| <b>Special features</b>                           |   |   |   |   |
| Characteristics                                   | Adjustable tripping currents  | -   | -   | -   |
| <b>Input</b>                                      |   |   |   |   |
| Input rated voltage                               | 24 Vdc  | 24 Vdc  | 24 Vdc  | 24 Vdc  |
| Input voltage range                               | 18 - 30 Vdc   | 18 - 30 Vdc   | 18 - 30 Vdc   | 18 - 30 Vdc   |
| Maximal residual ripple of supplied input voltage | 3 %   | 3 %   | 3 %   | 3 %   |
| Max. total input current                          | 10 A  | 1 A   | 2 A   | 3 A   |
| Max. input current for each pole of terminal      | 10 A (-), 40 A (+)  | 10 A (-), 40 A (+)  | 10 A (-), 40 A (+)  | 10 A (-), 40 A (+)  |
| Required input voltage for turning-on of outputs  | 17.5 V (Turn-off Threshold 16.7 V), ± 0.7 V   | 17.5 V (Turn-off Threshold 16.7 V), ± 0.7 V   | 17.5 V (Turn-off Threshold 16.7 V), ± 0.7 V   | 17.5 V (Turn-off Threshold 16.7 V), ± 0.7 V   |
| Max. power losses                                 | 0.4 W   | 1,2 W   | 1,3 W   | 1,4 W   |
| Over voltage protection                           | Suppressor diode 33 V   | Suppressor diode 33 V   | Suppressor diode 33 V   | Suppressor diode 33 V   |
| Stand-by current                                  | 39 mA @ 24 V  | 39 mA @ 24 V  | 39 mA @ 24 V  | 39 mA @ 24 V  |
| Power losses in stand-by mode                     | 0.3 W @ 24 V  | 1,17 W @ 24 V   | 1,17 W @ 24 V   | 1,17 W @ 24 V   |
| Turn on capacity                                  | 50-110 mF @ 24 Vdc / 2,5 mm <sup>2</sup> / 2,5 m  | 110 mF @ 24 Vdc / 2,5 mm <sup>2</sup> / 2,5 m   | 130 mF @ 24 Vdc / 2,5 mm <sup>2</sup> / 2,5 m   | 120 mF @ 24 Vdc / 2,5 mm <sup>2</sup> / 2,5 m   |
| <b>Output</b>                                     |   |   |   |   |
| Output rated voltage                              | 24 Vdc  | 24 Vdc  | 24 Vdc  | 24 Vdc  |
| Maximum voltage drop between input and output     | 130 mV  | 58 mV   | 55 mV   | 82 mV   |
| Initialization time of module                     | 52 ms   | 52 ms   | 52 ms   | 52 ms   |
| Turn-on delay of outputs                          | min. 50 ms / max. 5 s   | min. 50 ms / max. 5 s   | min. 50 ms / max. 5 s   | min. 50 ms / max. 5 s   |
| Waiting periode after switch-off of an output     | 500 ms (Short circuit) .. 5 s (Overload)  | 500 ms (Short circuit) .. 5 s (Overload)  | 500 ms (Short circuit) .. 5 s (Overload)  | 500 ms (Short circuit) .. 5 s (Overload)  |
| Parallel use of outputs                           | Not allowed   | Not allowed   | Not allowed   | Not allowed   |
| Serial use of outputs                             | not allowed   | not allowed   | not allowed   | not allowed   |
| Resistance to reverse feed max.                   | 35 Vdc  | 35 Vdc  | 35 Vdc  | 35 Vdc  |
| Output rated current                              | 0.5 - 10 A, adjustable (0,5A, 1A, 2A, 3A, 4A, 5A, 6A, 8A, 10A)  | 1 A   | 2 A   | 3 A   |
| Efficiency  | 99.0 %  | 99.0 %  | 99.0 %  | 99.0 %  |
| Output limited current                            | typ. rated current x 1,25 (@ 1-10 A)<br>typ. rated current x 2,5 (@ 0,5 A)  | typ. 1,25 A   | typ. 2,5 A  | typ. 3,75 A   |
| <b>Signaling</b>                                  |   |   |   |   |
| Bus communication                                 | Read:-state (tripped, On, Off)<br>-set/ current<br>-input voltage<br>-firmware version/serial number<br>Write:-state (on, off, reset) | Read:-state (tripped, On, Off)<br>-set/active current<br>-input voltage<br>-firmware version/serial number<br>Write:-state (on, off, reset) | Read:-state (tripped, On, Off)<br>-set/active current<br>-input voltage<br>-firmware version/serial number<br>Write:-state (on, off, reset) | Read:-state (tripped, On, Off)<br>-set/active current<br>-input voltage<br>-firmware version/serial number<br>Write:-state (on, off, reset) |
| Status indicator                                  | LED (red, green, orange)  | LED (red, green, orange)  | LED (red, green, orange)  | LED (red, green, orange)  |
| Signal output                                     | Output status, short circuit proof<br>high = Channel on, low = Channel off, fault   | Output status, short circuit proof<br>high = Channel on, low = Channel off, fault   | Output status, short circuit proof<br>high = Channel on, low = Channel off, fault   | Output status, short circuit proof<br>high = Channel on, low = Channel off, fault   |
| Signal output (ON/OFF/Reset)                      | Reset input<br>Level high = min. 15V, max. 30V<br>Level low = min. 0V, max. 5V  | Reset input<br>Level high = min. 15V, max. 30V<br>Level low = min. 0V, max. 5V  | Reset input<br>Level high = min. 15V, max. 30V<br>Level low = min. 0V, max. 5V  | Reset input<br>Level high = min. 15V, max. 30V<br>Level low = min. 0V, max. 5V  |
| <b>Environment</b>                                |   |   |   |   |
| Type of cooling                                   | Natural convection  | Natural convection  | Natural convection  | Natural convection  |
| Ambient temperature                               | -25 °C to +70 °C  | -25 °C .. +70 °C  | -25 °C .. +70 °C  | -25 °C .. +70 °C  |
| Storage temperature                               | -25 °C ... +85 °C   | -25 °C ... +85 °C   | -25 °C ... +85 °C   | -25 °C ... +85 °C   |
| Derating  | max. +60 °C > 6A  | -   | -   | -   |
| Relative humidity                                 | 5 .. 96 %, without condensation   | 5 .. 96 %, without condensation   | 5 .. 96 %, without condensation   | 5 .. 96 %, without condensation   |
| Required minimum spacing (left/right)             | 0 mm  | 0 mm  | 0 mm  | 0 mm  |
| Required minimum spacing (over/under)             | 30 mm   | 30 mm   | 30 mm   | 30 mm   |
| <b>Safety and protection</b>                      |   |   |   |   |
| Protection index                                  | IP 20   | IP 20   | IP 20   | IP 20   |
| Safety class                                      | III, without PE connection  | III, without PE connection  | III, without PE connection  | III, without PE connection  |
| Degree of pollution                               | 2   | 2   | 2   | 2   |
| <b>Order numbers</b>                              |   |   |   |   |
| Order Number                                      | <b>EB-0824-100-0</b>  | <b>EB-1824-010-0</b>  | <b>EB-1824-020-0</b>  | <b>EB-1824-030-0</b>  |

1.1

1.2

1.3

2.1

2.2

3.1

3.2

3.3

4.0

5.1

5.2



## 1-Channel circuit breaker EasyB 1-Channel



|   |   | EB-1824-040-0   | EB-1824-060-0   | EB-1824-080-0   | EB-1824-100-0                               |
|---|---|---|---|---|---|
| Electrical data                               | Typ   | EB-1824-040-0   | EB-1824-060-0   | EB-1824-080-0   | EB-1824-100-0                               |
|   | Special features  |   |   |   |   |
|   | Characteristics   | -   | -   | -   | -   |
|   | Input   |   |   |   |   |
|   | Input rated voltage   | 24 Vdc  | 24 Vdc  | 24 Vdc  | 24 Vdc                                      |
|   | Input voltage range   | 18 - 30 Vdc   | 18 - 30 Vdc   | 18 - 30 Vdc   | 18 - 30 Vdc                                 |
|   | Maximal residual ripple of supplied input voltage   | 3 %   | 3 %   | 3 %   | 3 %   |
|   | Max. total input current  | 4 A   | 6 A   | 8 A   | 10 A  |
|   | Max. input current for each pole of terminal  | 10 A (-), 40 A (+)  | 10 A (-), 40 A (+)  | 10 A (-), 40 A (+)  | 10 A (-), 40 A (+)                          |
|   | Required input voltage for turning-on of outputs  | 17,5 V (Turn-off Threshold 16,7 V), ± 0,7 V   | 17,5 V (Turn-off Threshold 16,7 V), ± 0,7 V   | 17,5 V (Turn-off Threshold 16,7 V), ± 0,7 V   | 17,5 V (Turn-off Threshold 16,7 V), ± 0,7 V |
| Max. power losses                             | 1,5 W   | 1,8 W   | 2,0 W   | 2,5 W   |   |
| Over voltage protection                       | Suppressor diode 33 V   | Suppressor diode 33 V   | Suppressor diode 33 V   | Suppressor diode 33 V   |   |
| Stand-by current                              | 39 mA @ 24 V  | 39 mA @ 24 V  | 39 mA @ 24 V  | 39 mA @ 24 V  |   |
| Power losses in stand-by mode                 | 1,17 W @ 24 V   | 1,17 W @ 24 V   | 1,17 W @ 24 V   | 1,17 W @ 24 V   |   |
| Turn on capacity                              | 110 mF @ 24 Vdc / 2,5 mm <sup>2</sup> / 2,5 m   | 80 mF @ 24 Vdc / 2,5 mm <sup>2</sup> / 2,5 m  | 80 mF @ 24 Vdc / 2,5 mm <sup>2</sup> / 2,5 m  | 70 mF @ 24 Vdc / 2,5 mm <sup>2</sup> / 2,5 m  |   |
| Output  |   |   |   |   |   |
| Output rated voltage                          | 24 Vdc  | 24 Vdc  | 24 Vdc  | 24 Vdc  |   |
| Maximum voltage drop between input and output | 70 mV   | 100 mV  | 105 mV  | 130 mV  |   |
| Initialization time of module                 | 52 ms   | 52 ms   | 52 ms   | 52 ms   |   |
| Turn-on delay of outputs                      | min. 50 ms / max. 5 s   | min. 50 ms / max. 5 s   | min. 50 ms / max. 5 s   | min. 50 ms / max. 5 s   |   |
| Waiting periode after switch-off of an output | 500 ms (Short circuit) .. 5 s (Overload)  | 500 ms (Short circuit) .. 5 s (Overload)  | 500 ms (Short circuit) .. 5 s (Overload)  | 500 ms (Short circuit) .. 5 s (Overload)  |   |
| Parallel use of outputs                       | Not allowed   | Not allowed   | Not allowed   | Not allowed   |   |
| Serial use of outputs                         | not allowed   | not allowed   | not allowed   | not allowed   |   |
| Resistance to reverse feed max.               | 35 Vdc  | 35 Vdc  | 35 Vdc  | 35 Vdc  |   |
| Output rated current                          | 4 A   | 6 A   | 8 A   | 10 A  |   |
| Efficiency                                    | 99,0 %  | 99,0 %  | 99,0 %  | 99,0 %  |   |
| Output limited current                        | typ. 5 A  | typ. 7,5 A  | typ. 10 A   | typ. 12,5 A   |   |
| Signaling                                     |   |   |   |   |   |
| Bus communication                             | Read:-state (tripped, On, Off)<br>-set/active current<br>-input voltage<br>-firmware version/serial number<br>Write:-state (on, off, reset) | Read:-state (tripped, On, Off)<br>-set/active current<br>-input voltage<br>-firmware version/serial number<br>Write:-state (on, off, reset) | Read:-state (tripped, On, Off)<br>-set/active current<br>-input voltage<br>-firmware version/serial number<br>Write:-state (on, off, reset) | Read:-state (tripped, On, Off)<br>-set/active current<br>-input voltage<br>-firmware version/serial number<br>Write:-state (on, off, reset) |   |
| Status indicator                              | LED (red, green, orange)  | LED (red, green, orange)  | LED (red, green, orange)  | LED (red, green, orange)  |   |
| Signal output                                 | Output status, short circuit proof<br>high = Channel on, low = Channel off, fault   | Output status, short circuit proof<br>high = Channel on, low = Channel off, fault   | Output status, short circuit proof<br>high = Channel on, low = Channel off, fault   | Output status, short circuit proof<br>high = Channel on, low = Channel off, fault   |   |
| Signal output (ON/OFF/Reset)                  | Reset input<br>Level high = min. 15V, max. 30V<br>Level low = min. 0V, max. 5V  | Reset input<br>Level high = min. 15V, max. 30V<br>Level low = min. 0V, max. 5V  | Reset input<br>Level high = min. 15V, max. 30V<br>Level low = min. 0V, max. 5V  | Reset input<br>Level high = min. 15V, max. 30V<br>Level low = min. 0V, max. 5V  |   |
| Environment                                   |   |   |   |   |   |
| Type of cooling                               | Natural convection  | Natural convection  | Natural convection  | Natural convection  |   |
| Ambient temperature                           | -25 °C .. +70 °C  | -25 °C .. +70 °C  | -25 °C .. +60 °C  | -25 °C .. +60 °C  |   |
| Storage temperature                           | -25 °C ... +85 °C   | -25 °C ... +85 °C   | -25 °C ... +85 °C   | -25 °C ... +85 °C   |   |
| Derating                                      | -   | -   | -   | -   |   |
| Relative humidity                             | 5 .. 96 %, without condensation   | 5 .. 96 %, without condensation   | 5 .. 96 %, without condensation   | 5 .. 96 %, without condensation   |   |
| Required minimum spacing (left/right)         | 0 mm  | 0 mm  | 0 mm  | 0 mm  |   |
| Required minimum spacing (over/under)         | 30 mm   | 30 mm   | 30 mm   | 30 mm   |   |
| Safety and protection                         |   |   |   |   |   |
| Protection index                              | IP 20   | IP 20   | IP 20   | IP 20   |   |
| Safety class                                  | III, without PE connection  | III, without PE connection  | III, without PE connection  | III, without PE connection  |   |
| Degree of pollution                           | 2   | 2   | 2   | 2   |   |
| Order numbers                                 |   |   |   |   |   |
| Order Number                                  | EB-1824-040-0   | EB-1824-060-0   | EB-1824-080-0   | EB-1824-100-0   |   |



## 1-Channel circuit breaker EasyB 1-Channel



| Typ   | EB-2724-010-0   | EB-2724-020-0   | EB-2724-030-0   | EB-2724-040-0   |
|---|---|---|---|---|
| <b>Electrical data</b>                            |   |   |   |   |
| Special features                                  |   |   |   |   |
| Characteristics                                   | -   | -   | -   | -   |
| Input   |   |   |   |   |
| Input rated voltage                               | 24 Vdc  | 24 Vdc  | 24 Vdc  | 24 Vdc  |
| Input voltage range                               | 18 - 30 Vdc   | 18 - 30 Vdc   | 18 - 30 Vdc   | 18 - 30 Vdc   |
| Maximal residual ripple of supplied input voltage | 3 %   | 3 %   | 3 %   | 3 %   |
| Max. total input current                          | 1 A   | 2 A   | 3 A   | 4 A   |
| Max. input current for each pole of terminal      | 10 A (-), 40 A (+)  | 10 A (-), 40 A (+)  | 10 A (-), 40 A (+)  | 10 A (-), 40 A (+)  |
| Required input voltage for turning-on of outputs  | 17,5 V (Turn-off Threshold 16,7 V), ± 0,7 V                                       | 17,5 V (Turn-off Threshold 16,7 V), ± 0,7 V                                       | 17,5 V (Turn-off Threshold 16,7 V), ± 0,7 V                                       | 17,5 V (Turn-off Threshold 16,7 V), ± 0,7 V                                       |
| Max. power losses                                 | 0,4 W   | 0,4 W   | 0,4 W   | 0,4 W   |
| Over voltage protection                           | Suppressor diode 33 V   | Suppressor diode 33 V   | Suppressor diode 33 V   | Suppressor diode 33 V   |
| Stand-by current                                  | 12 mA @ 24 V  | 12 mA @ 24 V  | 12 mA @ 24 V  | 12 mA @ 24 V  |
| Power losses in stand-by mode                     | 0,3 W @ 24 V  | 0,3 W @ 24 V  | 0,3 W @ 24 V  | 0,3 W @ 24 V  |
| Turn on capacity                                  | 70 mF @ 24 Vdc / 2,5 mm <sup>2</sup> / 2,5 m                                      | 80 mF @ 24 Vdc / 2,5 mm <sup>2</sup> / 2,5 m                                      | 80 mF @ 24 Vdc / 2,5 mm <sup>2</sup> / 2,5 m                                      | 80 mF @ 24 Vdc / 2,5 mm <sup>2</sup> / 2,5 m                                      |
| Output  |   |   |   |   |
| Output rated voltage                              | 24 Vdc  | 24 Vdc  | 24 Vdc  | 24 Vdc  |
| Maximum voltage drop between input and output     | 24 mV   | 29 mV   | 33 mV   | 34 mV   |
| Initialization time of module                     | 27 ms   | 27 ms   | 27 ms   | 27 ms   |
| Turn-on delay of outputs                          | 0 ms  | 0 ms  | 0 ms  | 0 ms  |
| Waiting periode after switch-off of an output     | 500 ms (Short circuit) .. 5 s (Overload)  | 500 ms (Short circuit) .. 5 s (Overload)  | 500 ms (Short circuit) .. 5 s (Overload)  | 500 ms (Short circuit) .. 5 s (Overload)  |
| Parallel use of outputs                           | Not allowed   | Not allowed   | Not allowed   | Not allowed   |
| Serial use of outputs                             | not allowed   | not allowed   | not allowed   | not allowed   |
| Resistance to reverse feed max.                   | 35 Vdc  | 35 Vdc  | 35 Vdc  | 35 Vdc  |
| Output rated current                              | 1 A   | 2 A   | 3 A   | 4 A   |
| Efficiency  | 99,0 %  | 99,0 %  | 99,0 %  | 99,0 %  |
| Output limited current                            | -   | -   | -   | -   |
| Signaling   |   |   |   |   |
| Bus communication                                 | Collective notification signal bypassed   | Collective notification signal bypassed   | Collective notification signal bypassed   | Collective notification signal bypassed   |
| Status indicator                                  | LED (red, green, orange)  | LED (red, green, orange)  | LED (red, green, orange)  | LED (red, green, orange)  |
| Signal output                                     | Output status, short circuit proof<br>high = Channel on, low = Channel off, fault | Output status, short circuit proof<br>high = Channel on, low = Channel off, fault | Output status, short circuit proof<br>high = Channel on, low = Channel off, fault | Output status, short circuit proof<br>high = Channel on, low = Channel off, fault |
| Signal output (ON/OFF/Reset)                      | -   | -   | -   | -   |
| Environment                                       |   |   |   |   |
| Type of cooling                                   | Natural convection  | Natural convection  | Natural convection  | Natural convection  |
| Ambient temperature                               | -25 °C .. +70 °C  | -25 °C .. +70 °C  | -25 °C .. +70 °C  | -25 °C .. +70 °C  |
| Storage temperature                               | -25 °C ... +85 °C   | -25 °C ... +85 °C   | -25 °C ... +85 °C   | -25 °C ... +85 °C   |
| Derating  | -   | -   | -   | -   |
| Relative humidity                                 | 5 .. 96 %, without condensation   | 5 .. 96 %, without condensation   | 5 .. 96 %, without condensation   | 5 .. 96 %, without condensation   |
| Required minimum spacing (left/right)             | 0 mm  | 0 mm  | 0 mm  | 0 mm  |
| Required minimum spacing (over/under)             | 30 mm   | 30 mm   | 30 mm   | 30 mm   |
| Safety and protection                             |   |   |   |   |
| Protection index                                  | IP 20   | IP 20   | IP 20   | IP 20   |
| Safety class                                      | III, without PE connection  | III, without PE connection  | III, without PE connection  | III, without PE connection  |
| Degree of pollution                               | 2   | 2   | 2   | 2   |
| Order numbers                                     |   |   |   |   |
| Order Number                                      | <b>EB-2724-010-0</b>  | <b>EB-2724-020-0</b>  | <b>EB-2724-030-0</b>  | <b>EB-2724-040-0</b>  |

1.1

1.2

1.3

2.1

2.2

3.1

3.2

3.3

4.0

5.1

5.2



## 1-Channel circuit breaker EasyB 1-Channel



| Typ   |   | EB-2724-060-0   | EB-2724-080-0   | EB-2724-100-0   | EB-2824-010-0                               |
|---|---|---|---|---|---|
| Electrical data                               | Special features  |   |   |   |   |
|   | Characteristics   | -   | -   | -   | -   |
|   | Input   |   |   |   |   |
|   | Input rated voltage   | 24 Vdc  | 24 Vdc  | 24 Vdc  | 24 Vdc                                      |
|   | Input voltage range   | 18 - 30 Vdc   | 18 - 30 Vdc   | 18 - 30 Vdc   | 18 - 30 Vdc                                 |
|   | Maximal residual ripple of supplied input voltage                                 | 3 %   | 3 %   | 3 %   | 3 %   |
|   | Max. total input current  | 6 A   | 8 A   | 10 A  | 1 A   |
|   | Max. input current for each pole of terminal                                      | 10 A (-), 40 A (+)  | 10 A (-), 40 A (+)  | 10 A (-), 40 A (+)  | 10 A (-), 40 A (+)                          |
|   | Required input voltage for turning-on of outputs                                  | 17,5 V (Turn-off Threshold 16,7 V), ± 0,7 V                                       | 17,5 V (Turn-off Threshold 16,7 V), ± 0,7 V                                       | 17,5 V (Turn-off Threshold 16,7 V), ± 0,7 V                                       | 17,5 V (Turn-off Threshold 16,7 V), ± 0,7 V |
|   | Max. power losses   | 0,6 W   | 0,9 W   | 1,2 W   | 0,6 W                                       |
| Over voltage protection                       | Suppressor diode 33 V   | Suppressor diode 33 V   | Suppressor diode 33 V   | Suppressor diode 33 V   |   |
| Stand-by current                              | 12 mA @ 24 V  | 12 mA @ 24 V  | 12 mA @ 24 V  | 18,6 mA @ 24 V  |   |
| Power losses in stand-by mode                 | 0,3 W @ 24 V  | 0,3 W @ 24 V  | 0,3 W @ 24 V  | 0,5 W @ 24 V  |   |
| Turn on capacity                              | 70 mF @ 24 Vdc / 2,5 mm <sup>2</sup> / 2,5 m                                      | 70 mF @ 24 Vdc / 2,5 mm <sup>2</sup> / 2,5 m                                      | 50 mF @ 24 Vdc / 2,5 mm <sup>2</sup> / 2,5 m                                      | 110 mF @ 24 Vdc / 2,5 mm <sup>2</sup> / 2,5 m                                     |   |
| Output  |   |   |   |   |   |
| Output rated voltage                          | 24 Vdc  | 24 Vdc  | 24 Vdc  | 24 Vdc  |   |
| Maximum voltage drop between input and output | 54 mV   | 72 mV   | 92 mV   | 58 mV   |   |
| Initialization time of module                 | 27 ms   | 27 ms   | 27 ms   | 52 ms   |   |
| Turn-on delay of outputs                      | 0 ms  | 0 ms  | 0 ms  | 0 ms  |   |
| Waiting periode after switch-off of an output | 500 ms (Short circuit) .. 5 s (Overload)  | 500 ms (Short circuit) .. 5 s (Overload)  | 500 ms (Short circuit) .. 5 s (Overload)  | 500 ms (Short circuit) .. 5 s (Overload)  |   |
| Parallel use of outputs                       | Not allowed   | Not allowed   | Not allowed   | Not allowed   |   |
| Serial use of outputs                         | not allowed   | not allowed   | not allowed   | not allowed   |   |
| Resistance to reverse feed max.               | 35 Vdc  | 35 Vdc  | 35 Vdc  | 35 Vdc  |   |
| Output rated current                          | 6 A   | 8 A   | 10 A  | 1 A   |   |
| Efficiency                                    | 99,0 %  | 99,0 %  | 99,0 %  | 99,0 %  |   |
| Output limited current                        | -   | -   | -   | typ. 1,25 A   |   |
| Signaling                                     |   |   |   |   |   |
| Bus communication                             | Collective notification signal bypassed   | Collective notification signal bypassed   | Collective notification signal bypassed   | Collective notification signal bypassed   |   |
| Status indicator                              | LED (red, green, orange)  | LED (red, green, orange)  | LED (red, green, orange)  | LED (red, green, orange)  |   |
| Signal output                                 | Output status, short circuit proof<br>high = Channel on, low = Channel off, fault | Output status, short circuit proof<br>high = Channel on, low = Channel off, fault | Output status, short circuit proof<br>high = Channel on, low = Channel off, fault | Output status, short circuit proof<br>high = Channel on, low = Channel off, fault |   |
| Signal output (ON/OFF/Reset)                  | -   | -   | -   | -   |   |
| Environment                                   |   |   |   |   |   |
| Type of cooling                               | Natural convection  | Natural convection  | Natural convection  | Natural convection  |   |
| Ambient temperature                           | -25 °C .. +70 °C  | -25 °C .. +60 °C  | -25 °C .. +55 °C  | -25 °C .. +70 °C  |   |
| Storage temperature                           | -25 °C ... +85 °C   | -25 °C ... +85 °C   | -25 °C ... +85 °C   | -25 °C ... +85 °C   |   |
| Derating                                      | -   | -   | -   | -   |   |
| Relative humidity                             | 5 .. 96 %, without condensation   | 5 .. 96 %, without condensation   | 5 .. 96 %, without condensation   | 5 .. 96 %, without condensation   |   |
| Required minimum spacing (left/right)         | 0 mm  | 0 mm  | 0 mm  | 0 mm  |   |
| Required minimum spacing (over/under)         | 30 mm   | 30 mm   | 30 mm   | 30 mm   |   |
| Safety and protection                         |   |   |   |   |   |
| Protection index                              | IP 20   | IP 20   | IP 20   | IP 20   |   |
| Safety class                                  | III, without PE connection  | III, without PE connection  | III, without PE connection  | III, without PE connection  |   |
| Degree of pollution                           | 2   | 2   | 2   | 2   |   |
| Order numbers                                 |   |   |   |   |   |
| Order Number                                  | <b>EB-2724-060-0</b>  | <b>EB-2724-080-0</b>  | <b>EB-2724-100-0</b>  | <b>EB-2824-010-0</b>  |   |



## 1-Channel circuit breaker EasyB 1-Channel



|                                       | Typ   | EB-2824-020-0   | EB-2824-030-0   | EB-2824-040-0   | EB-2824-060-0                                |
|---------------------------------------|---|---|---|---|--|
| Electrical data                       | Special features  |   |   |   |  |
|                                       | Characteristics   | -   | -   | -   | -  |
|                                       | Input   |   |   |   |  |
|                                       | Input rated voltage   | 24 Vdc  | 24 Vdc  | 24 Vdc  | 24 Vdc                                       |
|                                       | Input voltage range   | 18 - 30 Vdc   | 18 - 30 Vdc   | 18 - 30 Vdc   | 18 - 30 Vdc                                  |
|                                       | Maximal residual ripple of supplied input voltage                                 | 3 %   | 3 %   | 3 %   | 3 %  |
|                                       | Max. total input current  | 2 A   | 3 A   | 4 A   | 6 A  |
|                                       | Max. input current for each pole of terminal                                      | 10 A (-), 40 A (+)  | 10 A (-), 40 A (+)  | 10 A (-), 40 A (+)  | 10 A (-), 40 A (+)                           |
|                                       | Required input voltage for turning-on of outputs                                  | 17,5 V (Turn-off Threshold 16,7 V), ± 0,7 V                                       | 17,5 V (Turn-off Threshold 16,7 V), ± 0,7 V                                       | 17,5 V (Turn-off Threshold 16,7 V), ± 0,7 V                                       | 17,5 V (Turn-off Threshold 16,7 V), ± 0,7 V  |
|                                       | Max. power losses   | 0,6 W   | 0,7 W   | 0,9 W   | 1,1 W  |
|                                       | Over voltage protection   | Suppressor diode 33 V   | Suppressor diode 33 V   | Suppressor diode 33 V   | Suppressor diode 33 V                        |
|                                       | Stand-by current  | 18,6 mA @ 24 V  | 18,6 mA @ 24 V  | 18,6 mA @ 24 V  | 18,6 mA @ 24 V                               |
|                                       | Power losses in stand-by mode   | 0,5 W @ 24 V  | 0,5 W @ 24 V  | 0,5 W @ 24 V  | 0,5 W @ 24 V                                 |
|                                       | Turn on capacity  | 130 mF @ 24 Vdc / 2,5 mm <sup>2</sup> / 2,5 m                                     | 120 mF @ 24 Vdc / 2,5 mm <sup>2</sup> / 2,5 m                                     | 110 mF @ 24 Vdc / 2,5 mm <sup>2</sup> / 2,5 m                                     | 80 mF @ 24 Vdc / 2,5 mm <sup>2</sup> / 2,5 m |
|                                       | Output  |   |   |   |  |
|                                       | Output rated voltage  | 24 Vdc  | 24 Vdc  | 24 Vdc  | 24 Vdc                                       |
|                                       | Maximum voltage drop between input and output                                     | 55 mV   | 82 mV   | 70 mV   | 100 mV                                       |
|                                       | Initialization time of module   | 52 ms   | 52 ms   | 52 ms   | 52 ms  |
|                                       | Turn-on delay of outputs  | 0 ms  | 0 ms  | 0 ms  | 0 ms   |
|                                       | Waiting periode after switch-off of an output                                     | 500 ms (Short circuit) .. 5 s (Overload)  | 500 ms (Short circuit) .. 5 s (Overload)  | 500 ms (Short circuit) .. 5 s (Overload)  | 500 ms (Short circuit) .. 5 s (Overload)     |
| Parallel use of outputs               | Not allowed   | Not allowed   | Not allowed   | Not allowed   |  |
| Serial use of outputs                 | not allowed   | not allowed   | not allowed   | not allowed   |  |
| Resistance to reverse feed max.       | 35 Vdc  | 35 Vdc  | 35 Vdc  | 35 Vdc  |  |
| Output rated current                  | 2 A   | 3 A   | 4 A   | 6 A   |  |
| Efficiency                            | 99,0 %  | 99,0 %  | 99,0 %  | 99,0 %  |  |
| Output limited current                | typ. 2,5 A  | typ. 3,75 A   | typ. 5 A  | typ. 7,5 A  |  |
| Signaling                             |   |   |   |   |  |
| Bus communication                     | Collective notification signal bypassed   | Collective notification signal bypassed   | Collective notification signal bypassed   | Collective notification signal bypassed   |  |
| Status indicator                      | LED (red, green, orange)  | LED (red, green, orange)  | LED (red, green, orange)  | LED (red, green, orange)  |  |
| Signal output                         | Output status, short circuit proof<br>high = Channel on, low = Channel off, fault | Output status, short circuit proof<br>high = Channel on, low = Channel off, fault | Output status, short circuit proof<br>high = Channel on, low = Channel off, fault | Output status, short circuit proof<br>high = Channel on, low = Channel off, fault |  |
| Signal output (ON/OFF/Reset)          | -   | -   | -   | -   |  |
| Environment                           |   |   |   |   |  |
| Type of cooling                       | Natural convection  | Natural convection  | Natural convection  | Natural convection  |  |
| Ambient temperature                   | -25 °C .. +70 °C  | -25 °C .. +70 °C  | -25 °C .. +70 °C  | -25 °C .. +70 °C  |  |
| Storage temperature                   | -25 °C ... +85 °C   | -25 °C ... +85 °C   | -25 °C ... +85 °C   | -25 °C ... +85 °C   |  |
| Derating                              | -   | -   | -   | -   |  |
| Relative humidity                     | 5 .. 96 %, without condensation   | 5 .. 96 %, without condensation   | 5 .. 96 %, without condensation   | 5 .. 96 %, without condensation   |  |
| Required minimum spacing (left/right) | 0 mm  | 0 mm  | 0 mm  | 0 mm  |  |
| Required minimum spacing (over/under) | 30 mm   | 30 mm   | 30 mm   | 30 mm   |  |
| Safety and protection                 |   |   |   |   |  |
| Protection index                      | IP 20   | IP 20   | IP 20   | IP 20   |  |
| Safety class                          | III, without PE connection  | III, without PE connection  | III, without PE connection  | III, without PE connection  |  |
| Degree of pollution                   | 2   | 2   | 2   | 2   |  |
| Order numbers                         |   |   |   |   |  |
| Order Number                          | <b>EB-2824-020-0</b>  | <b>EB-2824-030-0</b>  | <b>EB-2824-040-0</b>  | <b>EB-2824-060-0</b>  |  |

1.1

1.2

1.3

2.1

2.2

3.1

3.2

3.3

4.0

5.1

5.2



## 1-Channel circuit breaker EasyB 1-Channel



| Typ   | EB-2824-080-0   | EB-2824-100-0   | EB-3824-100-0   |
|---|---|---|---|
| <b>Electrical data</b>                            |   |   |   |
| <b>Special features</b>                           |   |   |   |
| Characteristics                                   | -   | -   | Adjustable tripping currents  |
| <b>Input</b>                                      |   |   |   |
| Input rated voltage                               | 24 Vdc  | 24 Vdc  | 24 Vdc  |
| Input voltage range                               | 18 - 30 Vdc   | 18 - 30 Vdc   | 18 - 30 Vdc   |
| Maximal residual ripple of supplied input voltage | 3 %   | 3 %   | 3 %   |
| Max. total input current                          | 8 A   | 10 A  | 10 A  |
| Max. input current for each pole of terminal      | 10 A (-), 40 A (+)  | 10 A (-), 40 A (+)  | 10 A (-), 40 A (+)  |
| Required input voltage for turning-on of outputs  | 17,5 V (Turn-off Threshold 16,7 V), ± 0,7 V                                       | 17,5 V (Turn-off Threshold 16,7 V), ± 0,7 V                                       | 17,5 V (Turn-off Threshold 16,7 V), ± 0,7 V   |
| Max. power losses                                 | 1,3 W   | 1,8 W   | 1,2 W - 2,5 W   |
| Over voltage protection                           | Suppressor diode 33 V   | Suppressor diode 33 V   | Suppressor diode 33 V   |
| Stand-by current                                  | 18,6 mA @ 24 V  | 18,6 mA @ 24 V  | 39 mA @ 24 V  |
| Power losses in stand-by mode                     | 0,5 W @ 24 V  | 0,5 W @ 24 V  | 1,17 W @ 24 V   |
| Turn on capacity                                  | 80 mF   | 70 mF @ 24 Vdc / 2,5 mm <sup>2</sup> / 2,5 m                                      | 50-110 mF @ 24 Vdc / 2,5 mm <sup>2</sup> / 2,5 m  |
| <b>Output</b>                                     |   |   |   |
| Output rated voltage                              | 24 Vdc  | 24 Vdc  | 24 Vdc  |
| Maximum voltage drop between input and output     | 92 mV   | 130 mV  | 130 mV  |
| Initialization time of module                     | 52 ms   | 52 ms   | 52 ms   |
| Turn-on delay of outputs                          | 0 ms  | 0 ms  | min. 50 ms / max. 5 s   |
| Waiting periode after switch-off of an output     | 500 ms (Short circuit) .. 5 s (Overload)  | 500 ms (Short circuit) .. 5 s (Overload)  | 500 ms (Short circuit) .. 5 s (Overload)  |
| Parallel use of outputs                           | Not allowed   | Not allowed   | Not allowed   |
| Serial use of outputs                             | not allowed   | not allowed   | not allowed   |
| Resistance to reverse feed max.                   | 35 Vdc  | 35 Vdc  | 35 Vdc  |
| Output rated current                              | 8 A   | 10 A  | 0,5 - 10 A, adjustable (0,5A, 1A, 2A, 3A, 4A, 5A, 6A, 8A, 10A)  |
| Efficiency  | 99,0 %  | 99,0 %  | 99,0 %  |
| Output limited current                            | typ. 10 A   | typ. 12,5 A   | typ. rated current x 1,25 (@ 1-10 A)<br>typ. rated current x 2,5 (@ 0,5 A)  |
| <b>Signaling</b>                                  |   |   |   |
| Bus communication                                 | Collective notification signal bypassed   | Collective notification signal bypassed   | Read:-state (tripped, On, Off)<br>-set/ current<br>-input voltage<br>-firmware version/serial number<br>Write:-state (on, off, reset) |
| Status indicator                                  | LED (red, green, orange)  | LED (red, green, orange)  | LED (red, green, orange)  |
| Signal output                                     | Output status, short circuit proof<br>high = Channel on, low = Channel off, fault | Output status, short circuit proof<br>high = Channel on, low = Channel off, fault | Output status, short circuit proof<br>high = Channel on, low = Channel off, fault   |
| Signal output (ON/OFF/Reset)                      | -   | -   | Reset input<br>Level high = min. 15V, max. 30V<br>Level low = min. 0V, max. 5V  |
| <b>Environment</b>                                |   |   |   |
| Type of cooling                                   | Natural convection  | Natural convection  | Natural convection  |
| Ambient temperature                               | -25 °C .. +60 °C  | -25 °C .. +60 °C  | -25 °C .. +70 °C  |
| Storage temperature                               | -25 °C ... +85 °C   | -25 °C ... +85 °C   | -25 °C ... +85 °C   |
| Derating  | -   | -   | max. +60 °C > 6A  |
| Relative humidity                                 | 5 .. 96 %, without condensation   | 5 .. 96 %, without condensation   | 5 .. 96 %, without condensation   |
| Required minimum spacing (left/right)             | 0 mm  | 0 mm  | 0 mm  |
| Required minimum spacing (over/under)             | 30 mm   | 30 mm   | 30 mm   |
| <b>Safety and protection</b>                      |   |   |   |
| Protection index                                  | IP 20   | IP 20   | IP 20   |
| Safety class                                      | III, without PE connection  | III, without PE connection  | III, without PE connection  |
| Degree of pollution                               | 2   | 2   | 2   |
| <b>Order numbers</b>                              |   |   |   |
| Order Number                                      | <b>EB-2824-080-0</b>  | <b>EB-2824-100-0</b>  | <b>EB-3824-100-0</b>  |



## 1-Channel circuit breaker EasyB 1-Channel



| Typ           | Terminals output, (spring clamp terminal) | Terminals input, (spring clamp terminal) | Terminals signalling, (spring clamp terminal) | Mounting position                     | Weight   | Width | Dimension picture (in mm) | A    | B    | C    | D    | E    | F    | G  |
|---------------|---|--|---|---------------------------------------|----------|-------|---------------------------|------|------|------|------|------|------|----|
|               |   |  |   |                                       |          |       |                           | 30   | 30   | 30   | 30   | 30   | 30   | 30 |
| EB-0824-100-0 | max 2,5 mm <sup>2</sup> (1 x "+")         | max. 16 mm <sup>2</sup>                  | max. 2,5 mm <sup>2</sup>                      | horizontal for standard rail DIN TS35 | 0.042 kg | 12 mm |                           | 61.2 | 53.7 | 64.5 | 14.8 | 99.3 | 51.7 | 12 |
| EB-1824-010-0 | max 2,5 mm <sup>2</sup> (1 x "+")         | max. 16 mm <sup>2</sup>                  | max. 2,5 mm <sup>2</sup>                      | horizontal for standard rail DIN TS35 | 0.042 kg | 12 mm |                           | 61.2 | 53.7 | 64.5 | 14.8 | 99.3 | 51.7 | 12 |
| EB-1824-020-0 | max 2,5 mm <sup>2</sup> (1 x "+")         | max. 16 mm <sup>2</sup>                  | max. 2,5 mm <sup>2</sup>                      | horizontal for standard rail DIN TS35 | 0.042 kg | 12 mm |                           | 61.2 | 53.7 | 64.5 | 14.8 | 99.3 | 51.7 | 12 |
| EB-1824-030-0 | max 2,5 mm <sup>2</sup> (1 x "+")         | max. 16 mm <sup>2</sup>                  | max. 2,5 mm <sup>2</sup>                      | horizontal for standard rail DIN TS35 | 0.042 kg | 12 mm |                           | 61.2 | 53.7 | 64.5 | 14.8 | 99.3 | 51.7 | 12 |
| EB-1824-040-0 | max 2,5 mm <sup>2</sup> (1 x "+")         | max. 16 mm <sup>2</sup>                  | max. 2,5 mm <sup>2</sup>                      | horizontal for standard rail DIN TS35 | 0.042 kg | 12 mm |                           | 61.2 | 53.7 | 64.5 | 14.8 | 99.3 | 51.7 | 12 |
| EB-1824-060-0 | max 2,5 mm <sup>2</sup> (1 x "+")         | max. 16 mm <sup>2</sup>                  | max. 2,5 mm <sup>2</sup>                      | horizontal for standard rail DIN TS35 | 0.042 kg | 12 mm |                           | 61.2 | 53.7 | 64.5 | 14.8 | 99.3 | 51.7 | 12 |
| EB-1824-080-0 | max 2,5 mm <sup>2</sup> (1 x "+")         | max. 16 mm <sup>2</sup>                  | max. 2,5 mm <sup>2</sup>                      | horizontal for standard rail DIN TS35 | 0.042 kg | 12 mm |                           | 61.2 | 53.7 | 64.5 | 14.8 | 99.3 | 51.7 | 12 |
| EB-1824-100-0 | max 2,5 mm <sup>2</sup> (1 x "+")         | max. 16 mm <sup>2</sup>                  | max. 2,5 mm <sup>2</sup>                      | horizontal for standard rail DIN TS35 | 0.042 kg | 12 mm |                           | 61.2 | 53.7 | 64.5 | 14.8 | 99.3 | 51.7 | 12 |
| EB-2724-010-0 | max 2,5 mm <sup>2</sup> (2 x "+")         | max. 16 mm <sup>2</sup>                  | max. 2,5 mm <sup>2</sup>                      | horizontal for standard rail DIN TS35 | 0.039 kg | 12 mm |                           | 61.2 | 53.7 | 64.5 | 14.8 | 99.3 | 51.7 | 12 |
| EB-2724-020-0 | max 2,5 mm <sup>2</sup> (2 x "+")         | max. 16 mm <sup>2</sup>                  | max. 2,5 mm <sup>2</sup>                      | horizontal for standard rail DIN TS35 | 0.039 kg | 12 mm |                           | 61.2 | 53.7 | 64.5 | 14.8 | 99.3 | 51.7 | 12 |
| EB-2724-030-0 | max 2,5 mm <sup>2</sup> (2 x "+")         | max. 16 mm <sup>2</sup>                  | max. 2,5 mm <sup>2</sup>                      | horizontal for standard rail DIN TS35 | 0.039 kg | 12 mm |                           | 61.2 | 53.7 | 64.5 | 14.8 | 99.3 | 51.7 | 12 |
| EB-2724-040-0 | max 2,5 mm <sup>2</sup> (2 x "+")         | max. 16 mm <sup>2</sup>                  | max. 2,5 mm <sup>2</sup>                      | horizontal for standard rail DIN TS35 | 0.039 kg | 12 mm |                           | 61.2 | 53.7 | 64.5 | 14.8 | 99.3 | 51.7 | 12 |
| EB-2724-060-0 | max 2,5 mm <sup>2</sup> (2 x "+")         | max. 16 mm <sup>2</sup>                  | max. 2,5 mm <sup>2</sup>                      | horizontal for standard rail DIN TS35 | 0.039 kg | 12 mm |                           | 61.2 | 53.7 | 64.5 | 14.8 | 99.3 | 51.7 | 12 |
| EB-2724-080-0 | max 2,5 mm <sup>2</sup> (2 x "+")         | max. 16 mm <sup>2</sup>                  | max. 2,5 mm <sup>2</sup>                      | horizontal for standard rail DIN TS35 | 0.039 kg | 12 mm |                           | 61.2 | 53.7 | 64.5 | 14.8 | 99.3 | 51.7 | 12 |
| EB-2724-100-0 | max 2,5 mm <sup>2</sup> (2 x "+")         | max. 16 mm <sup>2</sup>                  | max. 2,5 mm <sup>2</sup>                      | horizontal for standard rail DIN TS35 | 0.039 kg | 12 mm |                           | 61.2 | 53.7 | 64.5 | 14.8 | 99.3 | 51.7 | 12 |
| EB-2824-010-0 | max 2,5 mm <sup>2</sup> (2 x "+")         | max. 16 mm <sup>2</sup>                  | max. 2,5 mm <sup>2</sup>                      | horizontal for standard rail DIN TS35 | 0.040 kg | 12 mm |                           | 61.2 | 53.7 | 64.5 | 14.8 | 99.3 | 51.7 | 12 |
| EB-2824-020-0 | max 2,5 mm <sup>2</sup> (2 x "+")         | max. 16 mm <sup>2</sup>                  | max. 2,5 mm <sup>2</sup>                      | horizontal for standard rail DIN TS35 | 0.040 kg | 12 mm |                           | 61.2 | 53.7 | 64.5 | 14.8 | 99.3 | 51.7 | 12 |
| EB-2824-030-0 | max 2,5 mm <sup>2</sup> (2 x "+")         | max. 16 mm <sup>2</sup>                  | max. 2,5 mm <sup>2</sup>                      | horizontal for standard rail DIN TS35 | 0.040 kg | 12 mm |                           | 61.2 | 53.7 | 64.5 | 14.8 | 99.3 | 51.7 | 12 |
| EB-2824-040-0 | max 2,5 mm <sup>2</sup> (2 x "+")         | max. 16 mm <sup>2</sup>                  | max. 2,5 mm <sup>2</sup>                      | horizontal for standard rail DIN TS35 | 0.040 kg | 12 mm |                           | 61.2 | 53.7 | 64.5 | 14.8 | 99.3 | 51.7 | 12 |
| EB-2824-060-0 | max 2,5 mm <sup>2</sup> (2 x "+")         | max. 16 mm <sup>2</sup>                  | max. 2,5 mm <sup>2</sup>                      | horizontal for standard rail DIN TS35 | 0.040 kg | 12 mm |                           | 61.2 | 53.7 | 64.5 | 14.8 | 99.3 | 51.7 | 12 |

### Dimension pictures

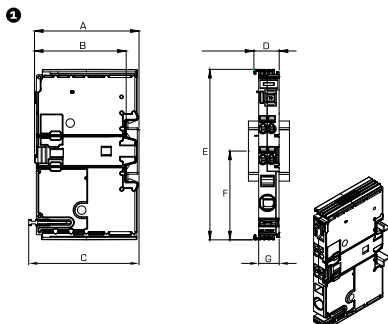





## 1-Channel circuit breaker EasyB 1-Channel



| Mechanical data | Type          | Terminals output, (spring clamp terminal) | Terminals input, (spring clamp terminal) | Terminals signalling, (spring clamp terminal) | Mounting position                     | Weight   | Width | Dimension picture (in mm) | A    | B    | C    | D    | E    | F    | G  |
|-----------------|---------------|---|--|---|---------------------------------------|----------|-------|---------------------------|------|------|------|------|------|------|----|
|                 |               |   |  |   |                                       |          |       |                           | 1    | 1    | 1    | 1    | 1    | 1    | 1  |
|                 | EB-2824-080-0 | max 2,5 mm <sup>2</sup> (2 x "+")         | max. 16 mm <sup>2</sup>                  | max. 2,5 mm <sup>2</sup>                      | horizontal for standard rail DIN TS35 | 0.040 kg | 12 mm | 1                         | 61.2 | 53.7 | 64.5 | 14.8 | 99.3 | 51.7 | 12 |
|                 | EB-2824-100-0 | max 2,5 mm <sup>2</sup> (2 x "+")         | max. 16 mm <sup>2</sup>                  | max. 2,5 mm <sup>2</sup>                      | horizontal for standard rail DIN TS35 | 0.040 kg | 12 mm | 1                         | 61.2 | 53.7 | 64.5 | 14.8 | 99.3 | 51.7 | 12 |
|                 | EB-3824-100-0 | max 2,5 mm <sup>2</sup> (1 x "+")         | max. 16 mm <sup>2</sup>                  | max. 2,5 mm <sup>2</sup>                      | horizontal for standard rail DIN TS35 | 0.042 kg | 12 mm | 1                         | 61.2 | 53.7 | 64.5 | 14.8 | 99.3 | 51.7 | 12 |

### Dimension pictures

